

DN	Gwint zewnętrzny złączki R	Waga [g]	~A [mm]	~B [mm]	~C [mm]	~D [mm]	min [mm]	max [mm]
15	1/2"	184	65	49	13	40,5	22	42
20	3/4"	269	72	56	16,5	47,5	22	45
25	1"	350	75	59,5	19	55	24	46
32	1 1/4"	578	85	67,5	21	67	24	53
40	1 1/2"	615	90	72,5	20	73	24	56
50	2"	1148	114	82,5	27	91	30	70

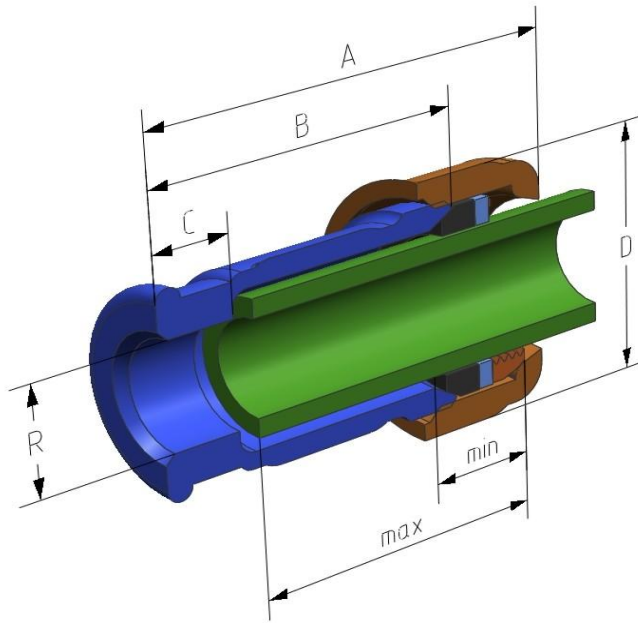

DN	Gwint wewnętrzny złączki R	Waga [g]	~A [mm]	~B [mm]	~C [mm]	~D [mm]	min [mm]	max [mm]
15	1/2"	202	65	49,5	12	40,5	22	45
20	3/4"	273	70	54,5	14	47,5	22	49
25	1"	361	75	59,5	18	55	24	51
32	1 1/4"	568	83	64,5	22	67	24	51
40	1 1/2"	596	86	69,5	19	73	24	58
50	2"	1094	110	79,5	30,5	91	30	67

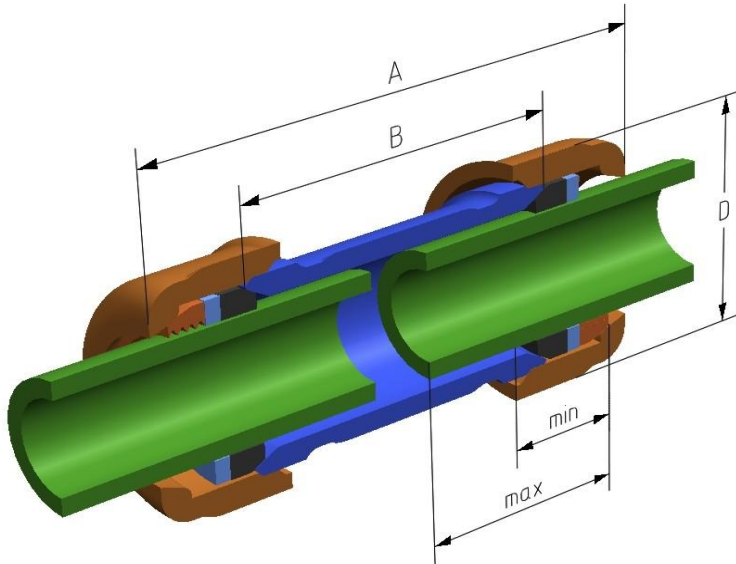

DN	Waga [g]	~A [mm]	~B [mm]	~D [mm]	min [mm]	max [mm]
15	285	85	54	40,5	22	35
20	395	90	60	47,5	22	35
25	500	95	64	55	24	40
32	803	105	69	67	24	45
40	773	108	74	73	24	45
50	1525		79	91	30	57

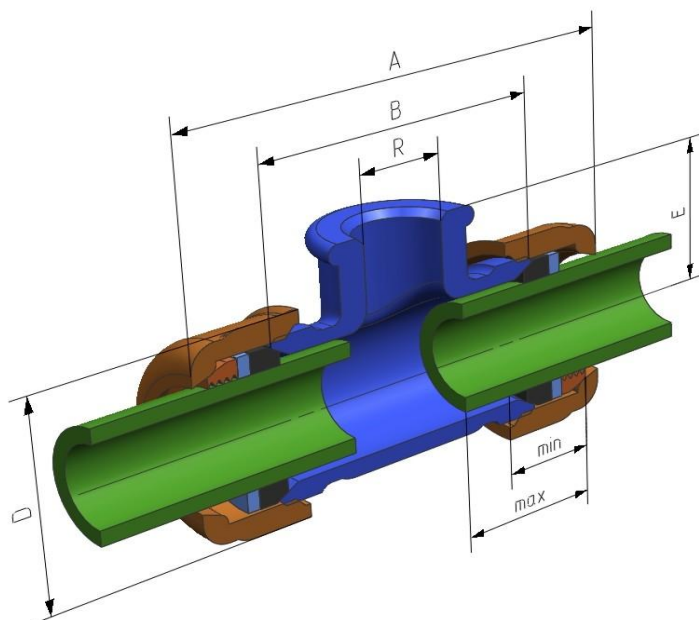

DN	Gwint wewnętrzny złączki R	Waga [g]	~A [mm]	~B [mm]	~D [mm]	~E [mm]	min [mm]	max [mm]
15	1/2"	344	89	58	40,5	30	22	37
20	3/4"	488	100	69	47,5	36	22	30
25	1"	626	110	79	55	40	24	30
32	1 1/4"	970	125	89	67	42	24	33
40	1 1/2"	1020	132	98	73	50	24	37
50	2"	1995	178	114	91	58	30	43